

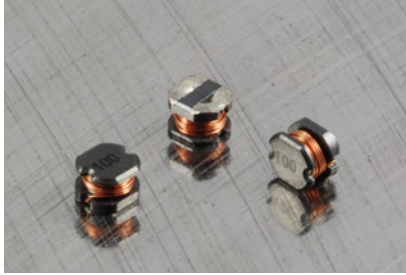

Power Chip Inductors PC0403

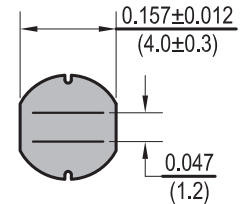

Dimensions: $\frac{\text{Inches}}{\text{(mm)}}$

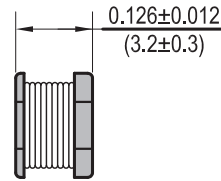
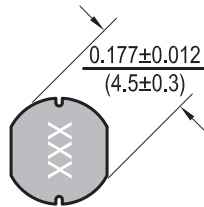

Allied Part Number	Inductance (μh)	Tolerance (%)	Test Freq.	DCR (Ω) Max.	IDC (A)
PC0403-1R0M-RC	1.0	20	7.96MHz,1V	.033	3.80
PC0403-1R2M-RC	1.2	20	7.96MHz,1V	.035	3.50
PC0403-1R4M-RC	1.4	20	7.96MHz,1V	.038	3.30
PC0403-1R8M-RC	1.8	20	7.96MHz,1V	.042	2.91
PC0403-2R2M-RC	2.2	20	7.96MHz,1V	.047	2.60
PC0403-2R7M-RC	2.7	20	7.96MHz,1V	.052	2.43
PC0403-3R3M-RC	3.3	20	7.96MHz,1V	.058	2.15
PC0403-3R9M-RC	3.9	20	7.96MHz,1V	.076	1.98
PC0403-4R7M-RC	4.7	20	7.96MHz,1V	.094	1.70
PC0403-5R6M-RC	5.6	20	7.96MHz,1V	.101	1.60
PC0403-6R8M-RC	6.8	20	7.96MHz,1V	.117	1.41
PC0403-8R2M-RC	8.2	20	7.96MHz,1V	.132	1.26
PC0403-100M-RC	10	20	2.52MHz,1V	.182	1.15
PC0403-120M-RC	12	20	2.52MHz,1V	.210	1.05
PC0403-150M-RC	15	20	2.52MHz,1V	.235	0.92
PC0403-180M-RC	18	20	2.52MHz,1V	.338	0.84
PC0403-220M-RC	22	20	2.52MHz,1V	.378	0.76
PC0403-270M-RC	27	20	2.52MHz,1V	.522	0.71
PC0403-330K-RC	33	10	2.52MHz,1V	.540	0.64
PC0403-390K-RC	39	10	2.52MHz,1V	.587	0.59
PC0403-470K-RC	47	10	2.52MHz,1V	.844	0.54
PC0403-560K-RC	56	10	2.52MHz,1V	.937	0.50
PC0403-680K-RC	68	10	2.52MHz,1V	1.117	0.46
PC0403-880K-RC	88	10	100KHz,1V	1.20	0.30
PC0403-101K-RC	100	10	1KHz,1V	2.00	0.40
PC0403-121K-RC	120	10	1KHz,1V	1.80	0.38
PC0403-221K-RC	220	10	100KHz,1V	4.00	0.15
PC0403-331K-RC	330	10	1KHz,1V	5.85	0.21

All specifications subject to change without notice.

Features

- Unshielded SMD Power Inductor
- Suitable for large currents
- Ideal for DC-DC converter applications
- Flat top for pick and place assembly

Electrical

Inductance Range: 1μh to 330μh

Tolerance: 20% over entire range

Also available in tighter tolerances

Operating Temp: -40°C ~ +85°C

IDC: Current at which Inductance drops 10% of its initial value or ΔT= 40 C whichever is lower.

Resistance to Soldering Heat

Test Method: Pre-Heat 150°C, 1 Min.

Solder Composition: Sn/Ag3.0/Cu0.5

Solder Temp: 260°C +/- 5°C for 10 sec ± 1 sec.

Test Equipment

(L): HP4192A LF Impedance Analyzer

(RDC): Chen Hwa 502BC

(IDC): HP4284A with HP42841A

Physical

Packaging: 2000 pieces per 13 inch reel.

Marking: EIA Inductance Code.